Ideas and Recommendations by Fraunhofer Advisory Group

Thailand / Bangkok · 2017-04-28

Fraunhofer Technology Advisory Group / EV Thailand

Felix Horch, Dr.-Ing. Stefan Lösch, Dr.-Ing. André Neumann,
Ralf Opierzynski, Dr.-Ing. Sabine Wagner

German Perspective on Collaborative Centers

Based on personal experiences

■ Strategic Vision and Objectives

- Common vision, overall strategic objectives and mutual benefits are the foundations for a sustainable innovation process
- Identification and integration of competent and reliable partners, especially to meet the industry's needs
- Commitment of every partner on a long-term perspective
- Alignment with governmental policies and frameworks

■ Attractive, representative and inspiring building and environment

- Natural support of collaboration and innovation by building and environment
- Modern research infrastructure, i.e. research facilities, public transport, campus atmosphere
- Signature architecture as a visible beacon



Examples of Collaborative Research Centers in Germany (NFF Braunschweig, OHLF Wolfsburg)

Example: Open Hybrid Lab Factory OHLF, Wolfsburg

<http://open-hybrid-labfactory.de/>

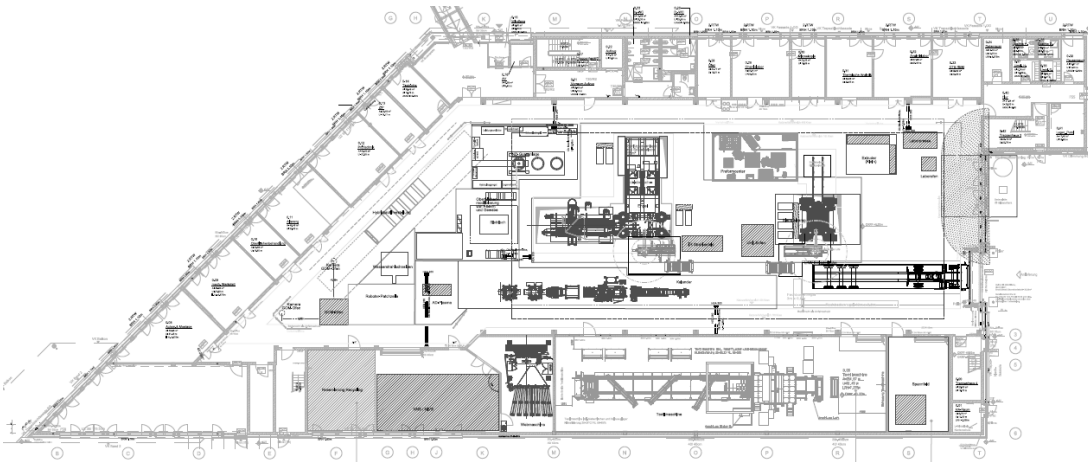

Proposal: Thai/German EVProject Excellence Center

Crucial factors for a sustainable cooperation

- **Appropriate personnel** – find the people who share common goals and feel the need to cooperate
- **Attractive infrastructure** – R&D needs an attractive home base and modern infrastructure that fosters cooperative development
- **Pilot projects** – content prioritization and goal-oriented projects are crucial to produce visible results and field test market acceptance
- **Common rules and defined processes** – Common rules are needed for an efficient teamwork, defined processes help to establish mutual cooperation and liability
- **Long-term financial commitment** – governmental and industrial partner have to commit themselves on a long-term perspective
- **Strategic and reliable legal framework** – to ensure return on investment for all partners

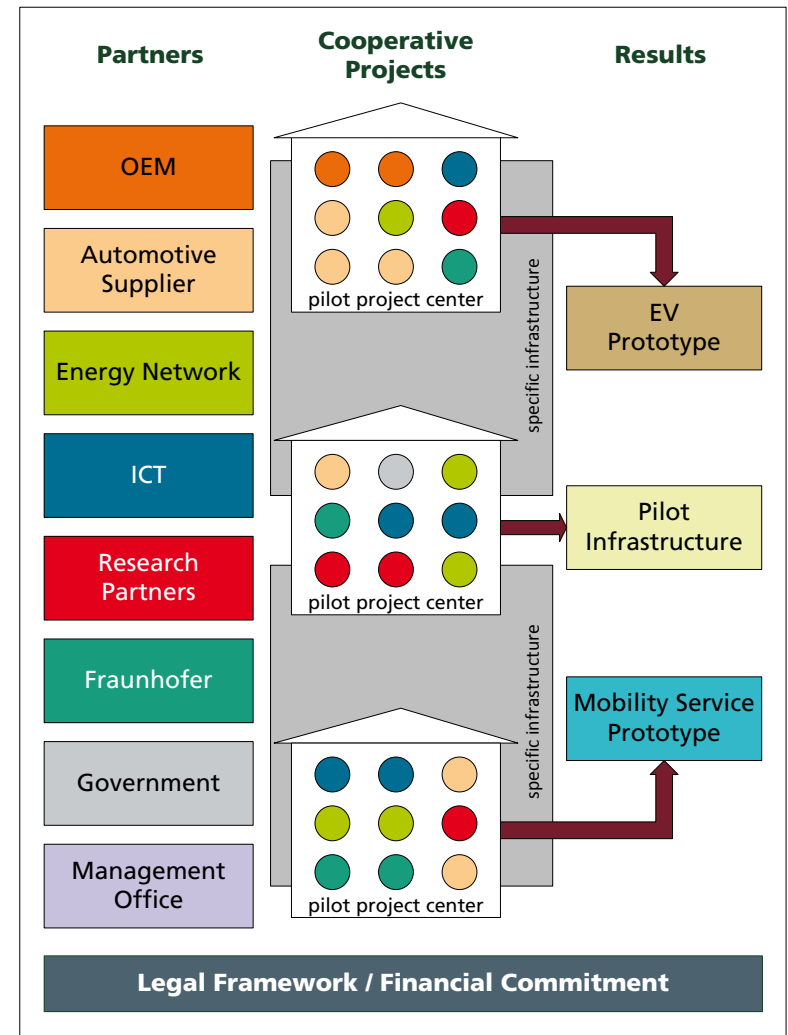

How can Fraunhofer contribute?

■ **Fraunhofer collaboration portfolio**

- Consulting & Strategy
- Certified training program
»Specialist for Electric Mobility«
by Fraunhofer Academy and IFAM
- Joint R&D-Projects
- Lab and testing services
- Lab infrastructure transfer
- License based technology / IP-transfer



Thai / Fraunhofer EV Core Team in Bangkok,
2017-04-26